

Tata Steel retain the right to ammend the construction and technical specifications shown on this drawing without prior notice.

TRISOMET® U-VALUES

135mm Core = 0.15 W/m² K
120mm Core = 0.16 W/m² K.
100mm Core = 0.20 W/m² K.
80mm Core = 0.25 W/m² K.
60mm Core = 0.33 W/m² K.
40mm Core = 0.46 W/m² K.

Psi & f-Factor

Y = 0.614W/mK.
f = 0.735

STATED CALCULATION RESULTS ARE DEPENDENT ON
COMPONENTS BEING AS SHOWN
Computer Modelled in accordance with EN ISO 10211



Building Systems UK
A Tata Steel enterprise

Technical Office - TEL : 01244 892199
www.buildingsystemsuk.co.uk

PROJECT

Trisomet Horizontal
Wall Details

TITLE

Window Jamb

DRAWN BY	LK	SCALE	NTS
----------	----	-------	-----

APPROVED BY	PS	TOLERANCES	
-------------	----	------------	--

DATE	25/05/23	DRG. No.	E5-012-03
------	----------	----------	-----------

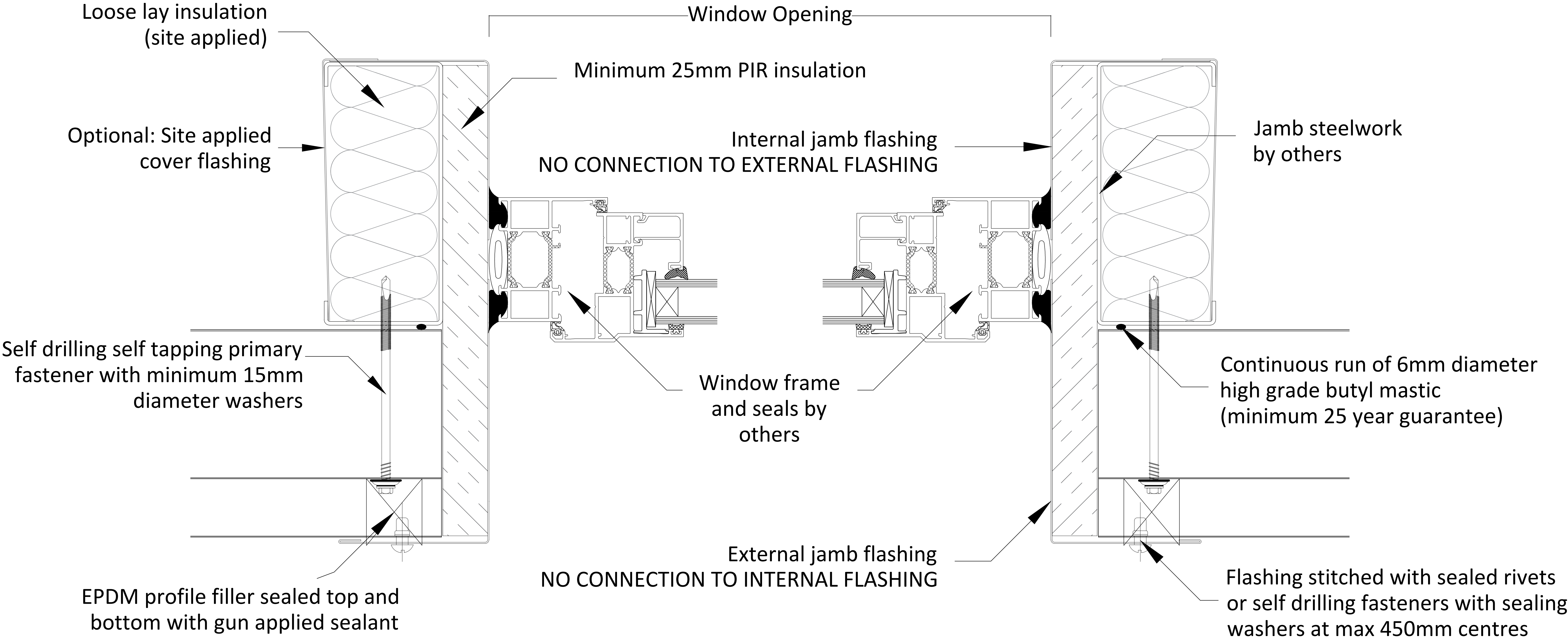

All support steelwork by
others