

Tata Steel retain the right to ammend the construction and technical specifications shown on this drawing without prior notice.

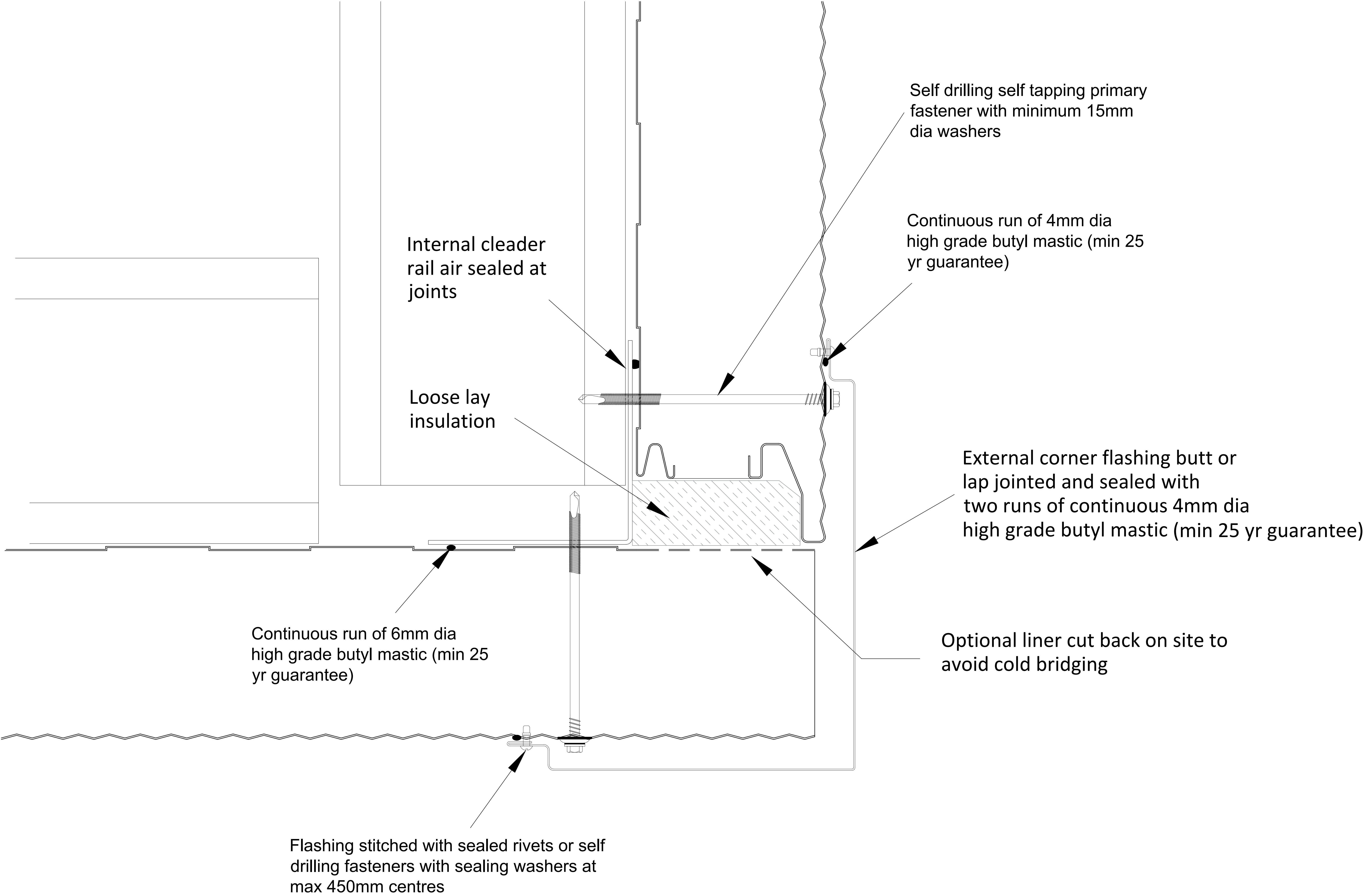

All support steelwork by others

TRISOMET® U-VALUES

Depth 70mm = 0.31 W/m² K
Depth 90mm = 0.24 W/m² K.
Depth 120mm = 0.17 W/m² K.

Junction Psi & f-Factor

With liner cut back	Without liner cut back
Y = 0.011W/mK.	Y = 0.17W/mK.
f = 0.977	f = 0.930

STATED CALCULATION RESULTS ARE DEPENDENT ON COMPONENTS BEING AS SHOWN
Computer Modelled in accordance with EN ISO 10211



Building Systems UK
A Tata Steel enterprise

Technical Office - TEL : 01244 892199
www.buildingsystemsuk.co.uk

PROJECT

Trimapanel System
Typical Details

TITLE

External Corner

DRAWN BY

LK

SCALE

NTS

APPROVED BY

PS

TOLERANCES

DATE

14/06/23

DRG. No.

W2-009-02