

Construction (Design and Management) Regulations  
 Design risk assessments are carried out throughout the design stage of this project in accordance with company procedures and manuals. Where reasonably possible all areas of risk applicable to design and end use of the construction have been identified and then eliminated, mitigated or recorded as a residual risk. Note that general risks of which a competent designer or contractor should be aware are not included. This drawing is to be read in conjunction with the Pre-construction Information and all related documents prepared in accordance with the current Construction (Design and Management) Regulations 2015 and all applicable Health and Safety legislation as currently amended.

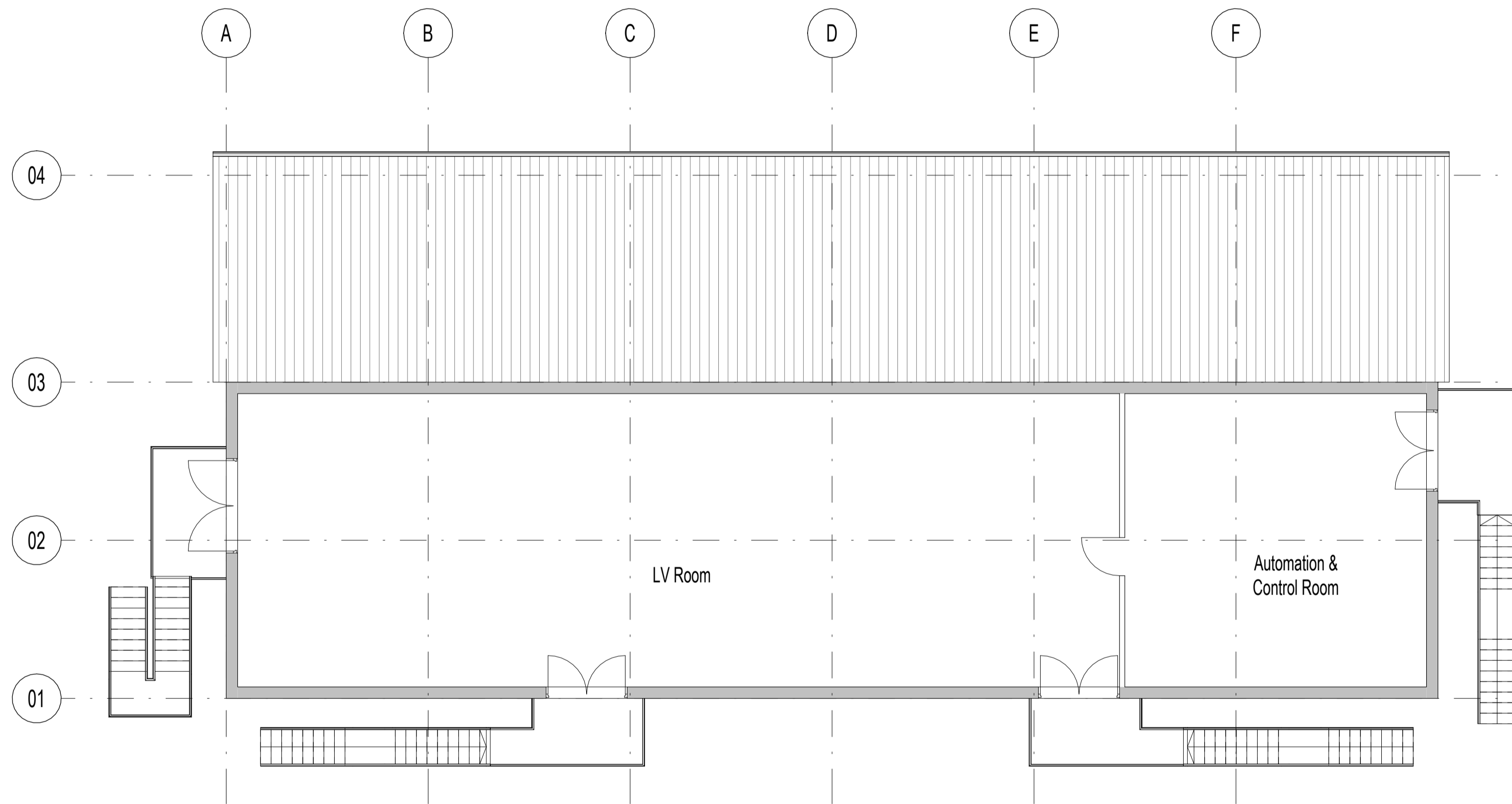

P01	Updated following NPT comments	05/09/2024			
P00	Issue to NPT	23/08/2024			
REV	DESCRIPTION	DRAWN BY	CHECKED BY	APPROVED BY	DATE
RIBA PLAN OF WORK WORKSTAGE	LEVEL OF MODEL DEFINITION (LoD)				
Stage 3 - Spatial Coordination	LoD 3 - Approximate Model				
PURPOSE OF ISSUE - SUITABLE FOR ...	STATUS or SUITABILITY				
Planning Submission	Status S2 - Delivery Team Information				

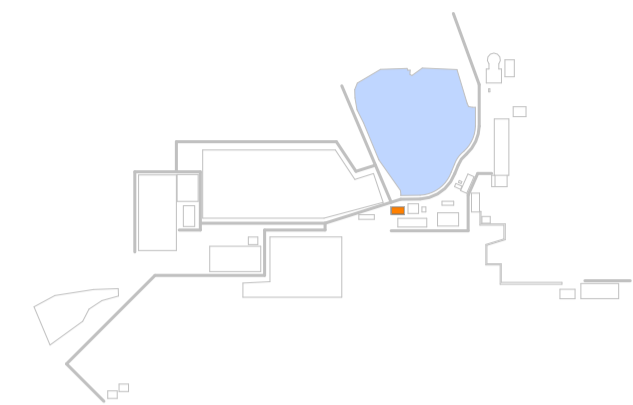

CARDIFF 029 2052 8140  
 LONDON 0207 138 3560  
 WREXHAM 01978 357 887  
 www.lawray.co.uk

CLIENT  
 Tata Steel UK Ltd.

PROJECT TITLE  
 EAF PROJECT, PORT TALBOT

DRAWING TITLE  
 Unit 11 - Melt Shop WTP Electrical Building -  
 Proposed First Floorplan

PROJECT No 20007 SCALE @ A2 As indicated

DRAWING No	1192: Project - Originator - Volume - Level - Type - Role - Number	REVISION
BS1192:2007	19650: Project - Originator - Functional - Spatial - Form - Discipline - Number	
+A2:2016) & BS EN ISO19650	Breakdown - Breakdown	
	<b>EAF-LAW-11-U01-DR-A-061002</b>	<b>P01</b>

DO NOT SCALE Any discrepancy or query concerning this drawing should be referred to the Architect  
 Copyright © LAWRAY LIMITED  
 Registered Office: Greenmeadow Springs, 1 Cae Gwynn, Tongwynlais, CARDIFF CF15 7AB  
 Reg. Co. No. 2724178, VAT Reg. No. 134 2146 06

U01 - First Floor Plan  
 1:100