

Trimapanel® U-values
Depth 70 = 0.31 W/m²K.
Depth 90 = 0.24 W/m²K.
Depth 120 = 0.17 W/m²K.



Tata Steel retain the right to amend the construction and technical specifications shown on this drawing without prior notice.

TATA STEEL

Sales Office - TEL: 01244 892199
Technical Office - TEL : 01244 892130
www.tatasteelconstruction.com/theworks

PROJECT
Trimapanel® System
Typical Details

TITLE
Stack Joint

DRAWN BY	SCALE
----------	-------

JCA NTS

APPROVED BY	TOLERANCES
-------------	------------

DA

DATE	DRG. No.
------	----------

22/11/10 W2-019-02-B

Self drilling self tapping
primary fastener with
minimum 15mm dia
washers

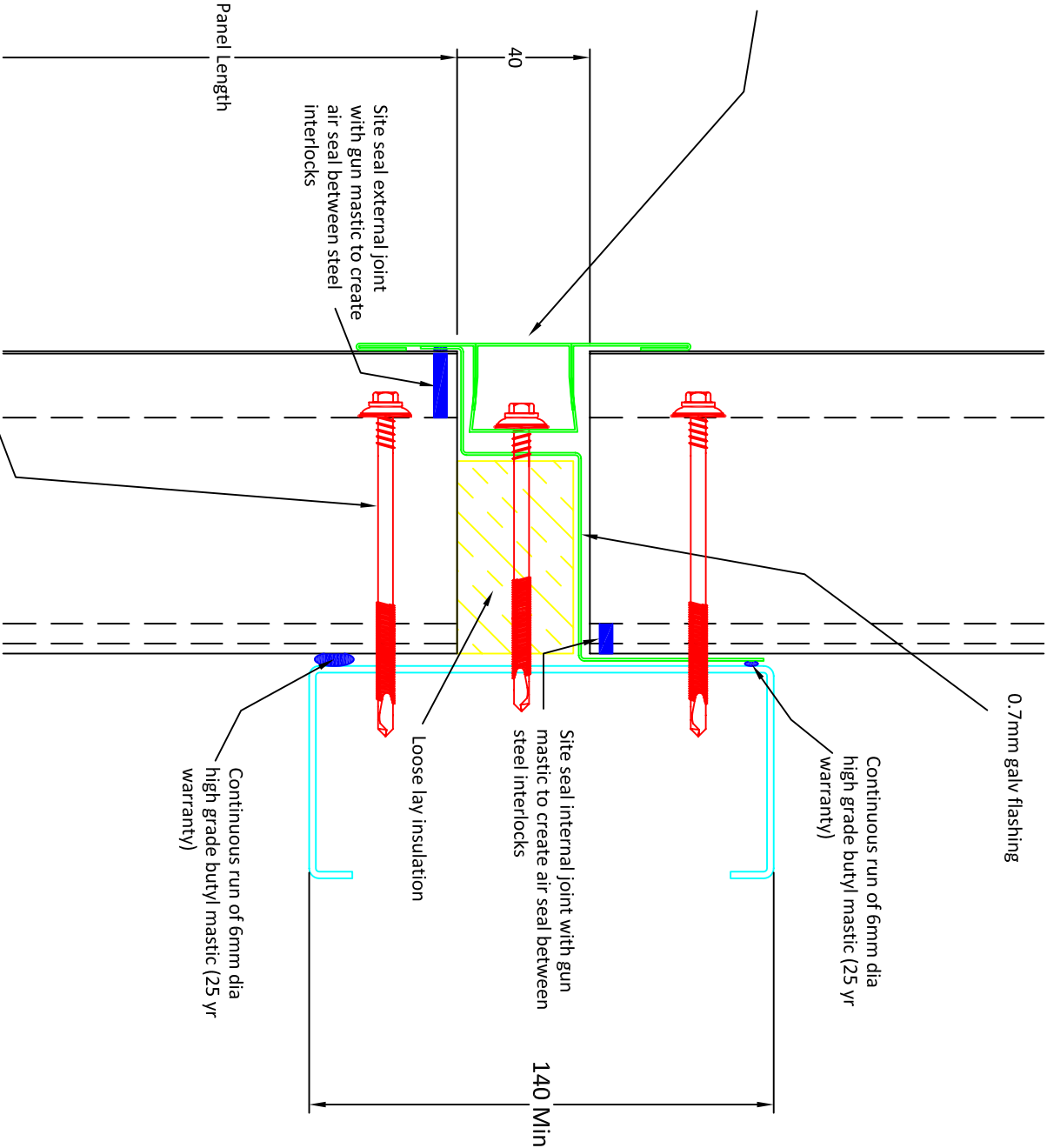

Folded 0.7mm Top hat and
insert cap system

0.7mm galv flashing

Continuous run of 6mm dia
high grade butyl mastic (25 yr
warranty)

Site seal internal joint with gun
mastic to create air seal between
steel interlocks

Loose lay insulation

Continuous run of 6mm dia
high grade butyl mastic (25 yr
warranty)

Site seal external joint
with gun mastic to create
air seal between steel
interlocks

Panel Length

40

140 Min

All support steelwork by
others